

PNEUMATIC LUBRICATOR SERIES 10



The reservoir is comprised of two die-cast aluminium flanges and a clear methacrylate or aluminium pipe, joined together by four galvanised steel tie rods.

It is equipped with a filter on the air intake side, a filter for the fluids inside and a 1/2 G filling plug. The upper flange, at the back, comes with M8 holes for fixing to the equipment.



IMPORTANT

Never pressurize the reservoir.

APPLICATIONS

The suction pumping unit is located at the bottom of the lubricator and comes complete with an out-flow regulator. A pneumatic pulse actuates the valve piston rod, which plunges into the chamber and forces fluid out through the fitting hole at the bottom.

When the signal is interrupted, the amount of liquid can be regulated on the knob provided as the piston rod retracts.

ORDERING CODES

Code	Description
Z52101001912075	750cc reservoir with methacrylate pipe
Z52101001912100	1000cc reservoir with methacrylate pipe
Z52101001912120	1200cc reservoir with methacrylate pipe

DIMENSIONS

* = Air supply

(#) = Oil outlet

(o) = Oil inlet

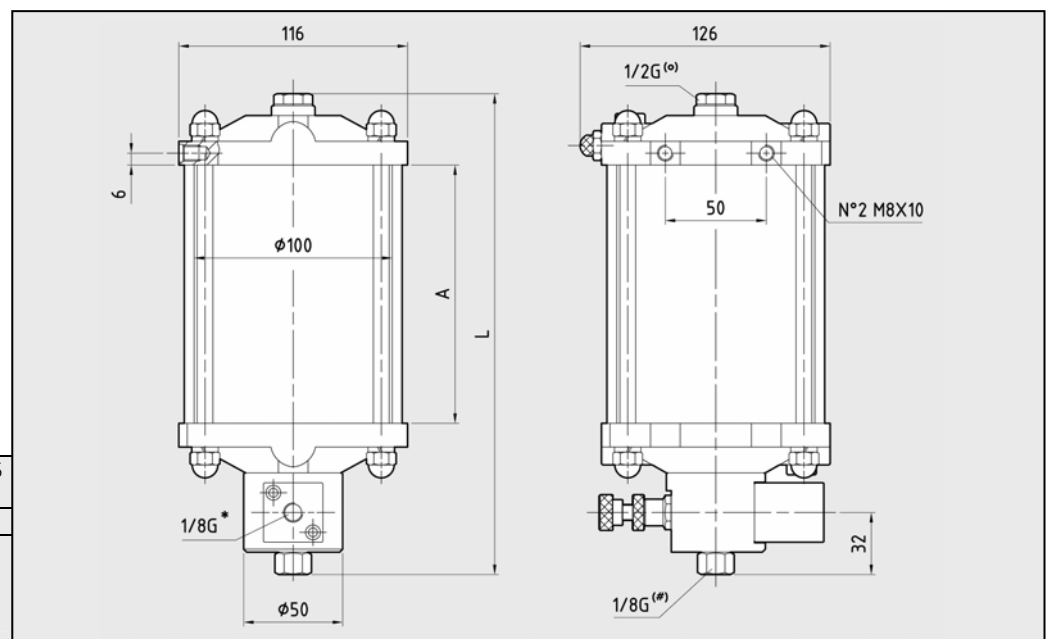

CODE	DIMENSIONS (mm)	
	A	L
Z52091001075	100	210
Z52091001100	130	240
Z52091001120	150	260

PNEUMATIC LUBRICATOR SERIES 10



SAMPLE APPLICATIONS

The figure shows a lubricator mounted on a machine tool.

OPERATION

A mechanically- or electrically-operated valve, mounted on the machine tool, sends a compressed air pulse directly to the valve (1). The valve piston rod plunges into the chamber and forces fluid out through flow port (2). This application is used to lubricate the part or tool at a precise point and at exactly the right moment.

